



c-Scroll

Large

- Extruded aluminum housing
- Die-cast aluminum end caps
- Integrated visor option - solid, perf or opal window
- Die-formed 94% reflective dual-finish anodized aluminum reflector
- Gasketed hinging doorframe - indoor toolless entry, outdoor - fasteners required
- PointGrab™ adjustment

Remote *(Consult factory for outdoor mounting)*

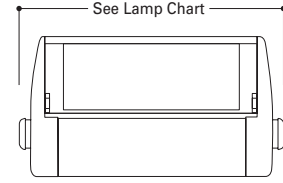
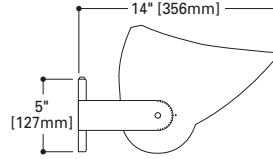
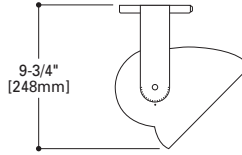

Integral

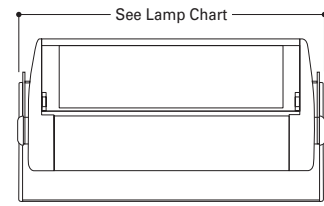
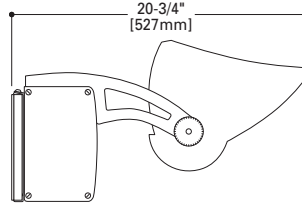
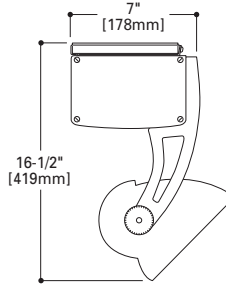

LAMP CHART - Remote

SOURCE	WATTAGE	LENGTH
Tungsten	350/500	22-3/4"
	900/1000	30-3/4"
Metal Halide	175	16-3/4"
	(2) 150/250/400	22-3/4"
	(2) 400	30-3/4"
Fluorescent	32/42/57	16-3/4"
	(2) 32/42	22-3/4"
	40/50/55	30-3/4"
	(2) 40/50/55	30-3/4"

LAMP CHART - Integral

SOURCE	WATTAGE	LENGTH
Metal Halide	175	16-3/4"
	(2) 150/250/400	22-3/4"
	(2) 400	30-3/4"
Fluorescent	32/42/57	16-3/4"
	(2) 32/42	22-3/4"
	40/50/55	30-3/4"
	(2) 40/50/55	30-3/4"

Mounting Options

YI01



YI02



YI03



YI04



CR36



ORDERING INFORMATION

SAMPLE NUMBER: SP-LI-P-1-M400-277-S-YR

Product	Size - Indoor/Outdoor	Lens	No. of Lamps	Lamp/Ballast Type	Wattage
<input type="checkbox"/> SN c-Scroll No Visor <input type="checkbox"/> SS c-Scroll Solid Visor <input type="checkbox"/> SO c-Scroll Opal Visor <input type="checkbox"/> SP c-Scroll Square Perf Visor	<input type="checkbox"/> LI Large Indoor <input type="checkbox"/> LO Large Outdoor	<input type="checkbox"/> C Clear <input type="checkbox"/> P Micro-prismatic <input type="checkbox"/> N None**	<input type="checkbox"/> 1 1 Lamp <input type="checkbox"/> 2 2 Lamps†	<input type="checkbox"/> F Fluorescent (Electronic) <input type="checkbox"/> T Tungsten Halogen <input type="checkbox"/> E Metal Halide* (Electronic) <input type="checkbox"/> M Metal Halide (Magnetic) <input type="checkbox"/> R Metal Halide (Restrike)	<input type="checkbox"/> 032 32W (F) † <input type="checkbox"/> 040 40W (F) † <input type="checkbox"/> 042 42W (F) † <input type="checkbox"/> 050 50W (F) † <input type="checkbox"/> 055 55W (F) † <input type="checkbox"/> 057 57W (F) <input type="checkbox"/> 150 150W (E) († only)
<input type="checkbox"/> 120 120V (T) <input type="checkbox"/> 220 277V (1000W only) <input type="checkbox"/> 240 240V (900W, 1000W only) <input type="checkbox"/> 277 277V <input type="checkbox"/> 347 347V	<input type="checkbox"/> W White <input type="checkbox"/> S Silver <input type="checkbox"/> B Bronze <input type="checkbox"/> C Custom (Consult factory)	<input type="checkbox"/> YR Yoke / Remote <input type="checkbox"/> CR36 Cantilever 36° Remote <input type="checkbox"/> YI01 Yoke Integral 01 <input type="checkbox"/> YI02 Yoke Integral 02 <input type="checkbox"/> YI03 Yoke Integral 03 <input type="checkbox"/> YI04 Yoke Integral 04	<input type="checkbox"/> MOD Provide description of the modification. (Consult factory)	<input type="checkbox"/> L45 45° Cross Blade Louver <input type="checkbox"/> L25 25° Cross Blade Louver	<input type="checkbox"/> 175 175W (M, R) <input type="checkbox"/> 250 250W (M, R) <input type="checkbox"/> 350 350W (T) <input type="checkbox"/> 400 400W (M, R) † <input type="checkbox"/> 500 500W (T) <input type="checkbox"/> 900 900W (T) <input type="checkbox"/> 01K 1000W (T)

* Not available with all sources or options. (Consult factory)

** Only fluorescent (Long Twin Tube)
† 2 lamp option

Specifications and dimensions subject to change without notice.